

The Elmhurst

Orbit Homes at Cromwell Wharf

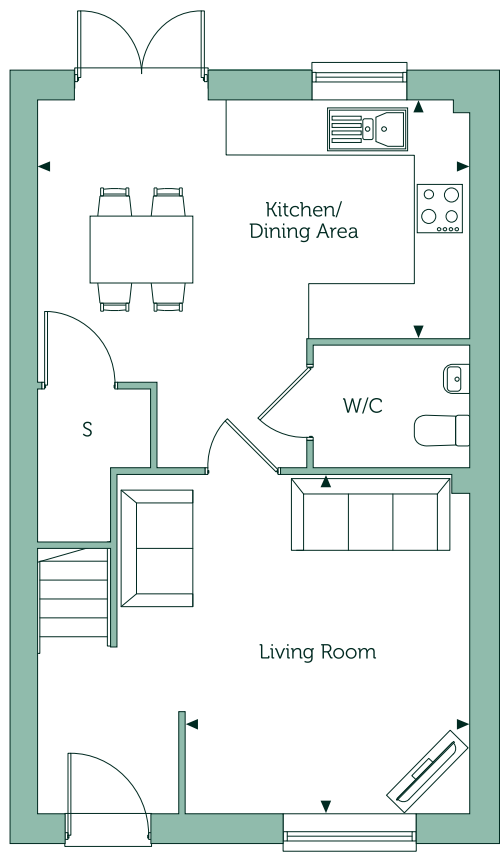

Ground Floor

Kitchen/Dining Area

16'10" x 10'11" 5.12m x 3.33m

Living Room

13'8" x 13'1" 4.16m x 4.00m

Handed Plots 192, 234, 266, 271, 281 & 357

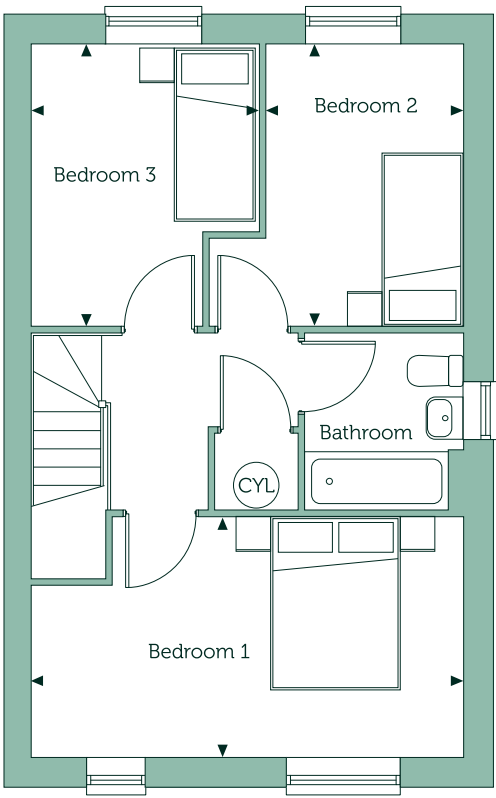

First Floor

Bedroom 1

16'10" x 9'3" 5.12m x 2.83m

Bedroom 2

9'10" x 10'11" 2.99m x 3.33m

Bedroom 3

8'10" x 10'11" 2.69m x 3.33m

Gross internal area

86.7 sqm 934.0 sqft

Key

S Store Cupboard **CYL** Hot Water Cylinder

Floorplans are not drawn to scale. Measurements are taken from areas marked ►. They are maximum approximate dimensions and given as a guide only. These should not be used as a basis for purchasing flooring or furniture. Orbit reserves the right to alter plans, specification, position of doors and windows and change tenure subject to demand without prior notice. External elevations vary from plot to plot. Please ask your Sales Consultant for current information when reserving your new home. Computer generated image overleaf. Information correct at time of going to print. November 2025. 07447-01.