

Marble Square

EXCLUSIVELY
SHARED
OWNERSHIP



Somewhere to call home

Marble Square

Site plan

- **The Eston**
2 bedroom home
- **The Buttercup**
2 bedroom home
- **The Hadley**
3 bedroom home
- **The Crimson**
3 bedroom home
- **The Meadowsweet**
3 bedroom home
- **The Laurel**
3 bedroom home
- **The Cornflower**
3 bedroom home
- **The Belgrave**
4 bedroom home
- **The Blackthorne**
3 bedroom home

SS: Electrical Substation



0115 671 0397 | sales@thesohub.co.uk | placesforpeople.co.uk/marble-square
Nightingale Road, Osmaston, Derby DE24 8BF



Please note: All CGIs, floor plans, configurations, maps and information are intended for guidance only and accuracy of this information cannot be relied upon by prospective purchasers who must make their own enquiries to satisfy themselves by inspection or otherwise as to the correct detail, including individual plot plans and colours. Sizes and dimensions approximate and subject to change. Correct at time of print – June 2025

Marble Square

The Blackthorne 3 bedroom home



Plot as drawn: 297
Plot handed: 319

79.6 sq.m / 857 sq.ft

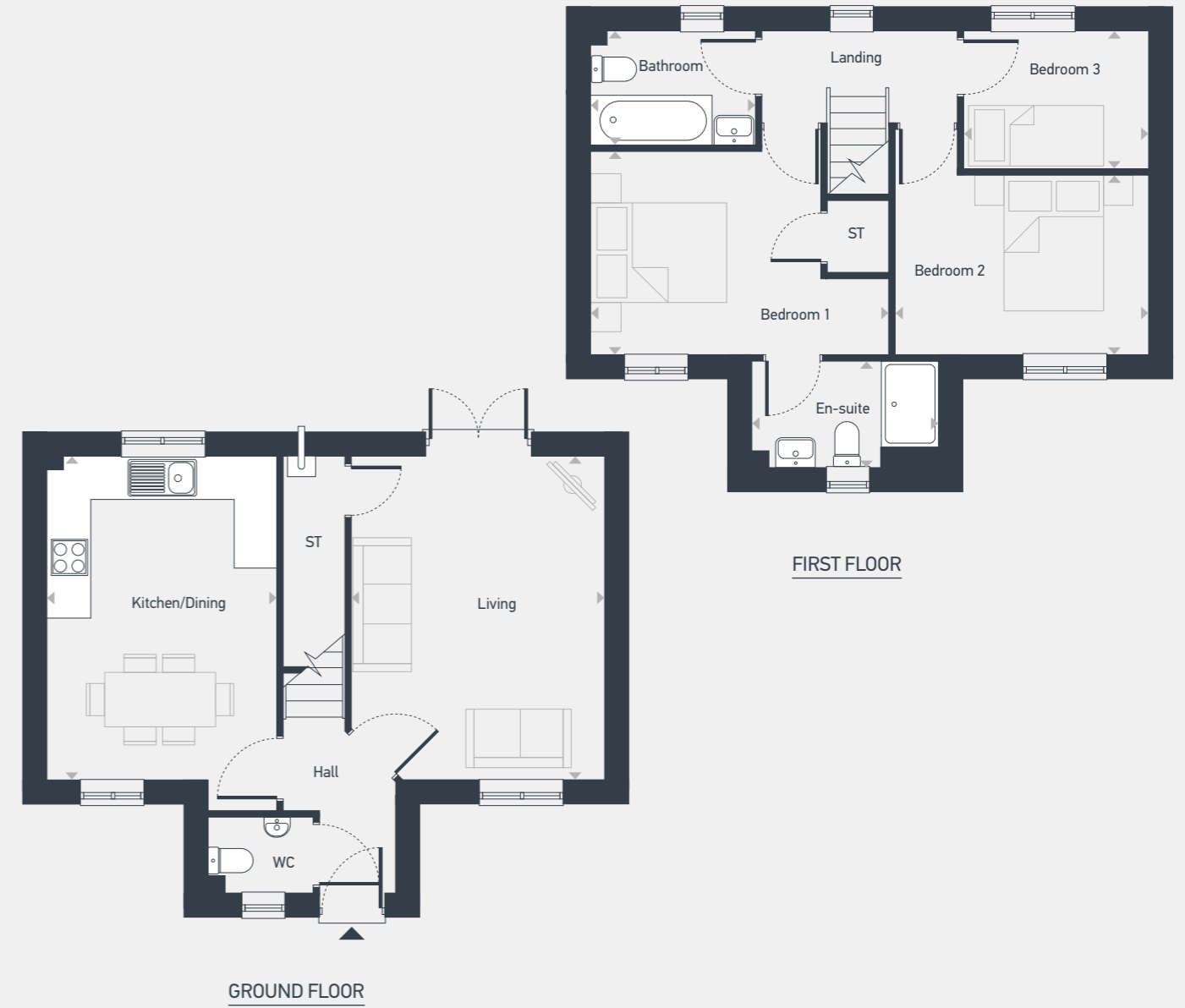

ST: Storage WC: Water Closet

DIMENSIONS	m	ft
Kitchen/Dining	4.51m x 3.20m	14'10" x 10'6"
Living	4.51m x 3.53m	14'10" x 11'7"

DIMENSIONS	m	ft
Bedroom 1	3.20m x 2.83m	10'6" x 9'3"
En-suite	2.61m x 1.48m	8'7" x 4'10"
Bedroom 2	3.53m x 2.50m	11'7" x 8'2"
Bedroom 3	2.57m x 1.92m	8'5" x 6'3"
Bathroom	2.29m x 1.59m	7'6" x 5'2"



KITCHENS

- Symphony fitted kitchen
- Laminate worktop
- Stainless steel single sink with chrome mixer tap
- Single electric oven with four-ring gas hob and stainless steel splashback
- Cooker hood
- Fridge/Freezer

PLUMBING AND HEATING

- Gas-fired combi boiler

ELECTRICAL

- Low energy light fittings and switching
- TV point to lounge and main bedroom
- White sockets and switches
- Mains-wired smoke detectors

BATHROOMS AND EN-SUITES

- White bathroom suite
- White wash basin pedestal unit with chrome mixer tap
- Porcelanosa tiles
- En-suite with white sanitaryware plus shower tray and glass shower screen (where applicable)

INTERNAL FINISHES

- Vinyl flooring in the kitchen, bathroom, W.C and en-suite (where applicable)
- Carpets in the remaining rooms

DOORS AND WINDOWS

- Multi-locking composite front door
- PVC double glazed windows

EXTERNAL

- Solar panels
- External lighting to the front
- Front garden landscaping
- Turfed rear garden
- Outside tap

A guide to shared ownership

What is shared ownership?

Shared Ownership is a government-backed scheme that could help you to get a foot on the property ladder.

At Marble Square, you can choose from a beautiful one, two or three bedroom home, all designed to exacting standards. And through the government-backed Shared Ownership scheme, you could be getting a foot on the property ladder more quickly than buying a home outright.

If you can't afford all of the deposit and mortgage payments for a home that meets your needs, Shared Ownership offers you the chance to buy an initial share of your home based on its market value and then pay rent on the remaining share — helping you to get on the property ladder more quickly than buying a home outright.

At Marble Square, you can purchase an initial share of your home between 25% and 75% of the property's value and pay rent on the rest. Even better, because you are buying a share of the property, the deposit you need to have saved is smaller too.

If you wish to in the future you can decide to buy further shares in your home, in stages or all at once, this is called staircasing. This will reduce the rent you have to pay, and you can increase your share gradually until you own 100% of your home.

How shared ownership works

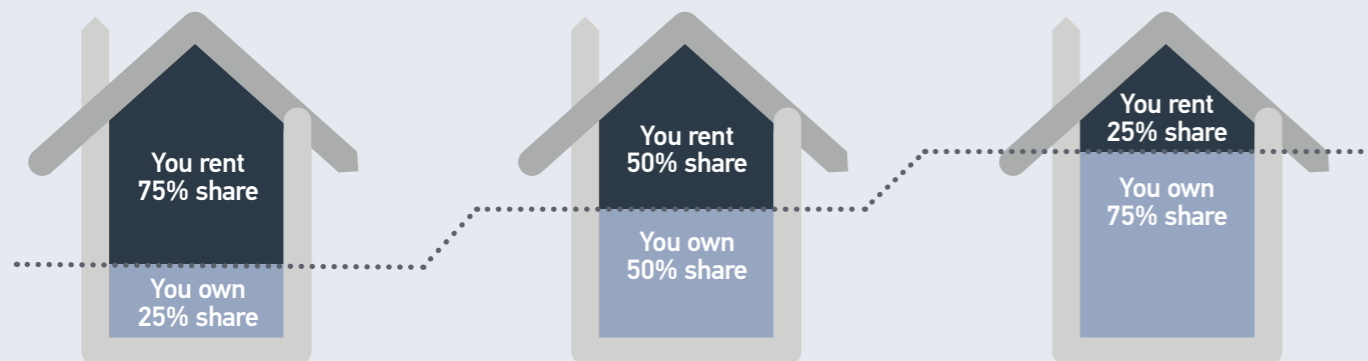

Your questions answered

Am I eligible for Shared Ownership?*

You can apply to buy with Shared Ownership if:

- You are a first-time buyer.
- You are an existing shared owner moving to another Shared Ownership home.
- You have previously owned a home but need help buying a new one.
- You have a combined household income less than £80,000.
- You are able to afford the mortgage, rent and service charges.

How much of my home can I afford to buy?

This will vary depending on your circumstances. An independent financial advisor will carry out an affordability assessment to determine the exact share that's right for you and your circumstances. They'll also carry out an affordability check with the most appropriate mortgage lender, to ensure you can get the amount you need to complete your purchase. This is all quite straightforward, and we can take care of it for you.

What is staircasing?

You can buy more shares in your home after you become the owner. This is known as 'staircasing'. This means that you can choose to increase the amount you own gradually, until you own 100% of your home.

How much does staircasing cost?

The cost of the additional shares will depend on the current market value of your home at the time you wish to buy more. When you buy more shares, you'll pay less rent.

Along with the cost of the additional shares that you are buying, there are other legal costs that you will need to consider. To find out more visit www.gov.uk/shared-ownership-scheme

What will my responsibilities be?

You will have a Shared Ownership lease which tells you your rights and responsibilities, which include being responsible for the maintenance and repairs on your home as well as paying your rent, service charges and your mortgage payments.

Do I need to pay Stamp Duty?

When you purchase a home through Shared Ownership, you can make a one-off Stamp Duty payment based on the total market value of the property, or alternatively, you can pay the Stamp Duty in stages. This means that you won't have to pay any Stamp Duty in the future when staircasing.

Alternatively, you can choose to pay the Stamp Duty in stages. There will be no Stamp Duty to pay until your owned share reaches 80% and above. If you are staircasing to 80% in your home, you will need to pay Stamp Duty on the share that took you over 80% and any further transactions.

I'm interested in Shared Ownership, now what?

Our sales team will be happy to discuss the Shared Ownership scheme with you and answer any questions you may have to help you find your perfect new home at Marble Square.



*Terms and conditions apply. Please talk to us for further details. Applications are subject to affordability and eligibility criteria..

**The places we make
are like nowhere else.
Because no one else makes
places the way we do.**

Because Community Matters

Proud to be creating sustainable
communities for the long term



Follow us on

 [@placesnewhomes](#)

 [@placesforpeopleofficial](#)

#BecauseCommunityMatters



placesforpeople.co.uk/marble-square
Nightingale Road, Osmaston, Derby DE24 8BF

Shared ownership terms and conditions apply. Please talk to us for further details. Applications are subject to affordability and eligibility criteria.

Places for People and any joint agents give notice that: 1. The text, photographs, computer generated images and plans are for guidance only and are not necessarily comprehensive. 2. These particulars were prepared from preliminary plans and specifications before the completion of the properties. These particulars, together with any images that they contain, are intended only as a guide. They may have been changed during construction and final finishes could vary. This information is for guidance only and does not form any part of any contract or constitute a warranty. 3. There may be changes throughout the build process to specific brands, materials and appliances referred to in the specification. In such cases, an alternative of similar quality will be provided.