

Prices  
from  
**£120,000**

# Bishops Green

BASS CLOSE, BISHOPS STORTFORD, HERTFORDSHIRE  
WILKINSON DRIVE, BISHOPS STORTFORD, HERTFORDSHIRE

A brand-new development of 2 & 3 bed houses

available through Shared Ownership

Trading as

**settle.**Paradigm



- £ Prices from £120,000 (30% share)
- 🏠 2 & 3-bedroom houses
- % Share available 25%-75% (3 beds)  
30%-75% (2 beds)



 **New Shared Ownership Homes Available**  
– Presented by SettleParadigm

SettleParadigm is delighted to offer **six stunning new build homes** available to purchase through the **Shared Ownership Scheme**. These beautifully designed **2 and 3-bedroom houses** are nestled in idyllic countryside surroundings, offering the perfect blend of rural charm and modern living.

Located just a short drive from the vibrant market town of **Bishop's Stortford**, residents will enjoy easy access to a wide range of amenities including shops, supermarkets, pubs, and restaurants. Plus, with a **direct rail link to London in under an hour**, commuting is a breeze.

Whether you're a first-time buyer or looking to step onto the property ladder, these homes offer an exceptional opportunity to own a slice of countryside living with excellent connectivity.



\*Disclaimer: Due to varying stages of construction, photographs are of similar properties and are intended to give an idea of the finish of the properties being built\*

## KEY FEATURES

White bathroom suite with thermostatic shower & heated towel rail

Carpet throughout living areas

Vinyl flooring in downstairs hallway, kitchen, bathroom & downstairs toilet

Air Source Heat Pumps

Allocated parking spaces with EV charging point

Fitted kitchen with integrated oven and ceramic hob, washer dryer & fridge freezer

Garden with turf

These particulars do not constitute any part of an offer or contract. Any intended purchasers must satisfy themselves as to the correctness of each of the statements contained in these particulars. All floor layouts may be subject to changes. The dimensions given on the plan are subject to minor variations intended for guidance only and are not to be used for carpets, appliances or items of furniture.

# SPECIFICATION

## KITCHEN

MANUFACTURER  
**Symphony**

COLOUR  
**Woodbury Platinum**

HANDLES  
**Chrome Chunky Bridge**

WORK TOP  
**Carbon Steel**

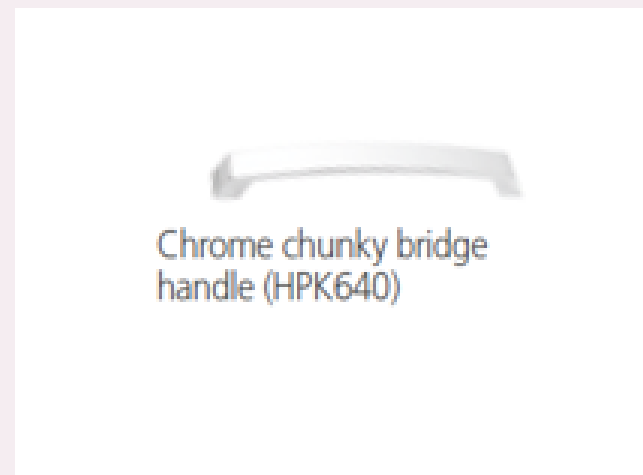
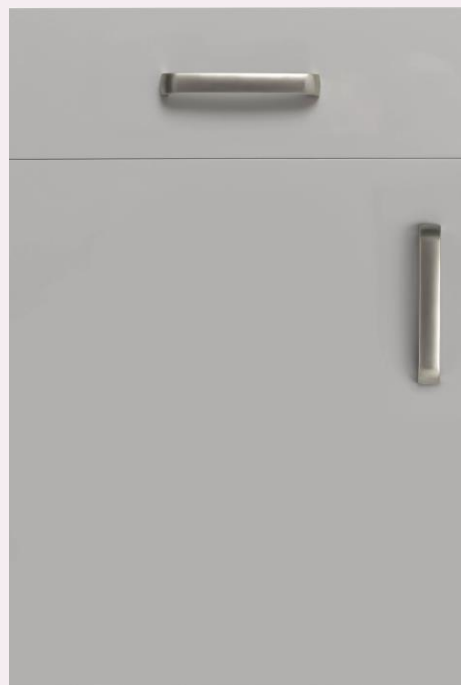

Chrome chunky bridge  
handle (HPK640)

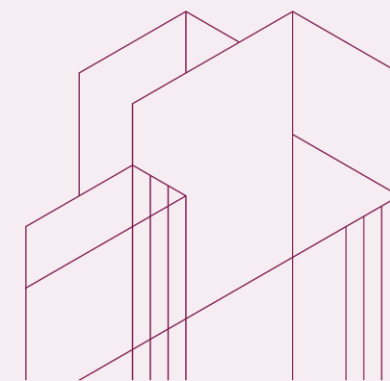

The specifications and information provided herein are for general informational purposes only and are subject to change without notice. Actual product colours may vary slightly due to differences in screen settings, lighting conditions, and the nature of physical materials. We strive for accuracy but cannot guarantee that digital imagery precisely reflects the final product.

# SPECIFICATION

## FLOORING

VINYL BRAND  
**Comfytex PU**

COLOUR  
**Toronto 517**

CARPET BRAND  
**Hampstead**

COLOUR  
**Florin**



The specifications and information provided herein are for general informational purposes only and are subject to change without notice. Actual product colours may vary slightly due to differences in screen settings, lighting conditions, and the nature of physical materials. We strive for accuracy but cannot guarantee that digital imagery precisely reflects the final product.

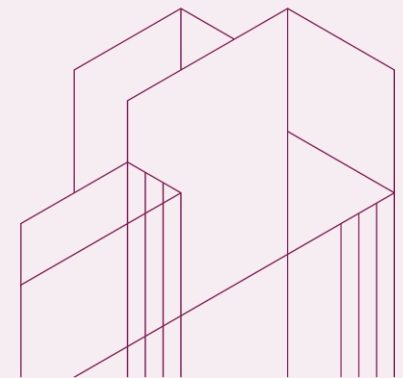

# SPECIFICATION

## BATHROOM WALL TILES

MANUFACTURER  
**Porcelanosa**

COLOUR  
**Bottega White**

### WALL TILES



Bottega White  
25X44.3cm  
Grout: Colorstuk Blanco

The specifications and information provided herein are for general informational purposes only and are subject to change without notice. Actual product colours may vary slightly due to differences in screen settings, lighting conditions, and the nature of physical materials. We strive for accuracy but cannot guarantee that digital imagery precisely reflects the final product.

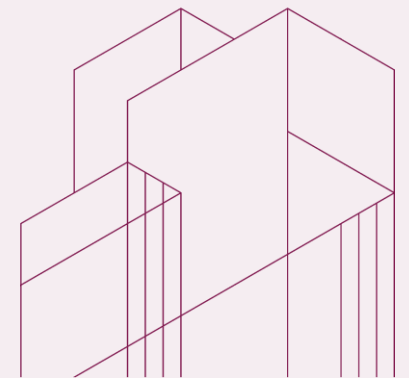



## Two Bedroom House Plots 54, 56 & 57

(\* handed)

### KITCHEN/DINING

14'11" x 9'8" 4.56m x 2.97m

### LIVING ROOM

14'11" x 12'3" 4.56m x 3.74m

### BEDROOM 1

14'9" x 10'6" 4.51m x 3.22m

### BEDROOM 2

14'9" x 10'11" 4.51m x 3.34m

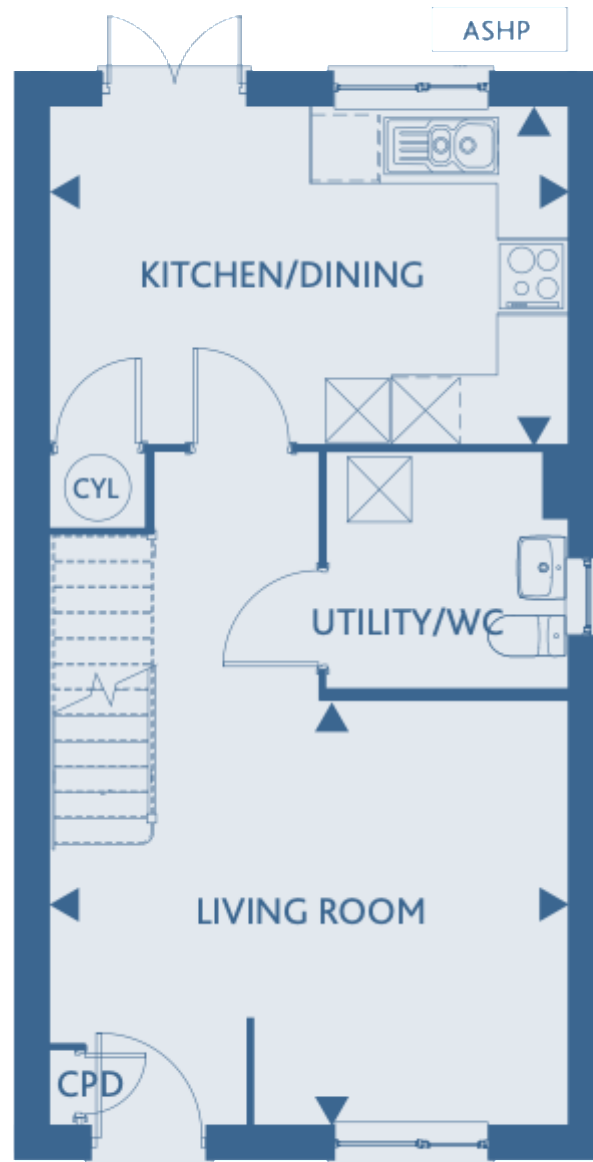

GROUND FLOOR

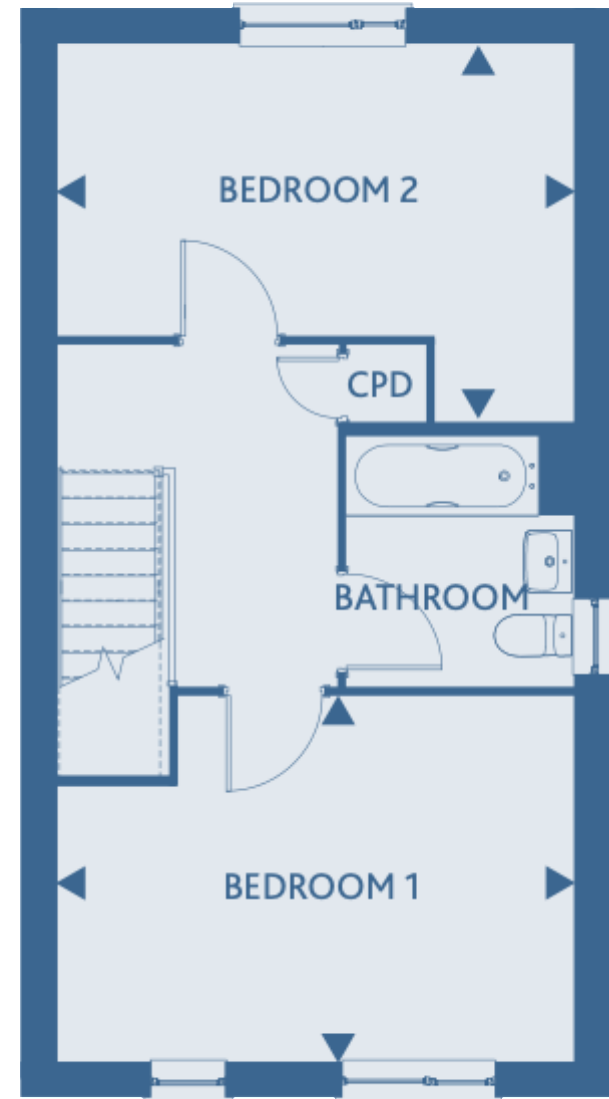

FIRST FLOOR

These particulars do not constitute any part of an offer or contract. Any intended purchasers must satisfy themselves as to the correctness of each of the statements contained in these particulars. All floor layouts may be subject to changes. The dimensions given on the plan are subject to minor variations intended for guidance only and are not to be used for carpets, appliances or items of furniture.





## Three Bedroom House Plots 7\* & 8

(\* handed)

### KITCHEN/DINING

17'4" x 9'1" 5.29m x 2.79m

### LIVING ROOM

10'7" x 12'9" 3.23m x 3.90m

### BEDROOM 1

8'10" x 15'10" 2.71m x 4.84m

### BEDROOM 2

9'11" x 13'2" 3.04m x 4.02m

### BEDROOM 3

8'5" x 9'10" 2.57m x 3.00m

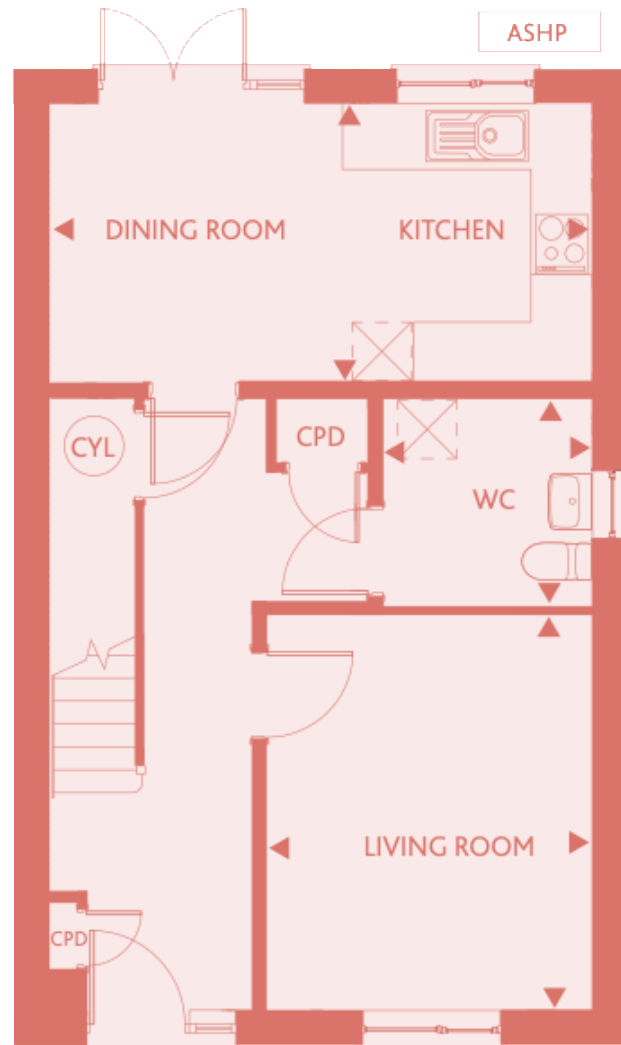

GROUND FLOOR

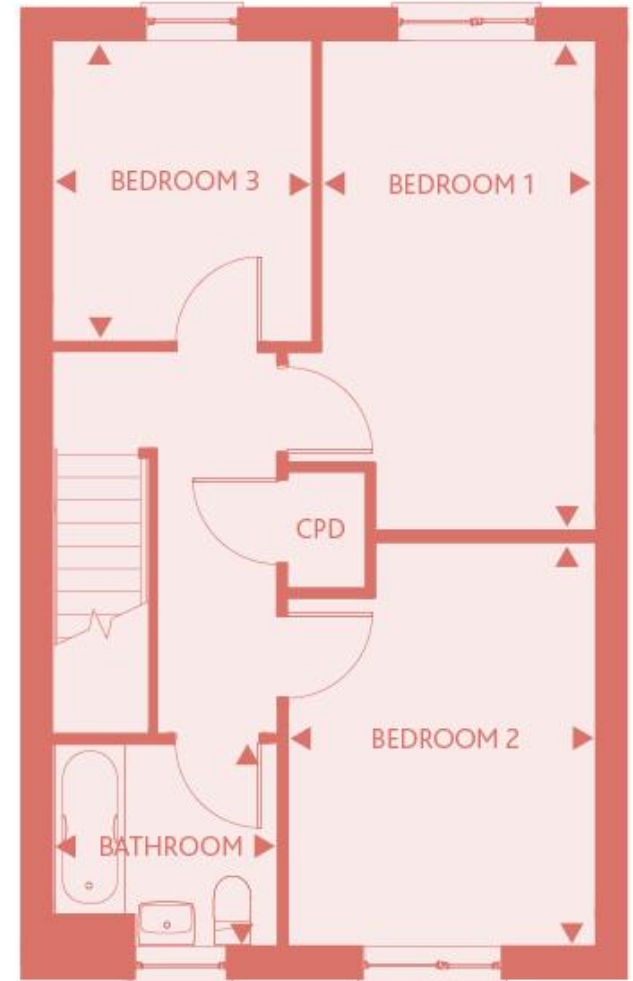

FIRST FLOOR

These particulars do not constitute any part of an offer or contract. Any intended purchasers must satisfy themselves as to the correctness of each of the statements contained in these particulars. All floor layouts may be subject to changes. The dimensions given on the plan are subject to minor variations intended for guidance only and are not to be used for carpets, appliances or items of furniture.





## Three Bedroom House Plots 53\*

(\* handed)

### KITCHEN/DINING

18'1" x 10'8" 5.52m x 3.26m

### LIVING ROOM

18'3" x 10'9" 5.57m x 3.24m

### BEDROOM 1

13'10" x 18'2" 4.24m x 5.54m

### BEDROOM 2

13'10" x 10'10" 4.24m x 3.32m

### BEDROOM 3

8'10" x 9'2" 2.70m x 2.81m



FIRST FLOOR





GROUND FLOOR

These particulars do not constitute any part of an offer or contract. Any intended purchasers must satisfy themselves as to the correctness of each of the statements contained in these particulars. All floor layouts may be subject to changes. The dimensions given on the plan are subject to minor variations intended for guidance only and are not to be used for carpets, appliances or items of furniture.



# SITE PLAN

**Key:**

-  EV Charging Units
-  Affordable Rented Homes
-  Retaining Wall

**Split Level Gardens Approx Steps Key:**

Plot 7	8 steps
Plot 8	8 steps

**Please note:** As the properties are situated on a hill, **gardens may not be completely level.**



\*Plots 27 & 28 will be released at a later date

These particulars do not constitute any part of an offer or contract. Any intended purchasers must satisfy themselves as to the correctness of each of the statements contained in these particulars. All floor layouts maybe subject to changes. The dimensions given on the plan are subject to minor variations intended for guidance only and are not be used for carpets, appliances or items of furniture.

Trading as  
**settle.**Paradigm

**For more information**

0300 303 8046

[www.settlesales.co.uk](http://www.settlesales.co.uk)

These particulars do not constitute any part of an offer or contract. Any intended purchasers must satisfy themselves as to the correctness of each of the statements contained in these particulars. All floor layouts may be subject to changes. The dimensions given on the plan are subject to minor variations intended for guidance only and are not to be used for carpets, appliances or items of furniture.

