

**The
Gwel**

**The Tintagel
3 bedroom home**



Plot as drawn: 110
Handed: 111

104.0 sq.m / 1,119 sq.ft

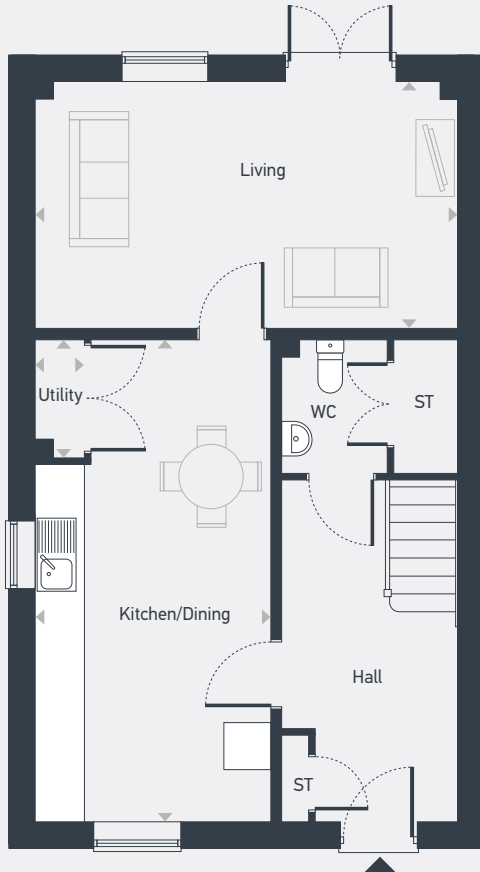

GROUND FLOOR

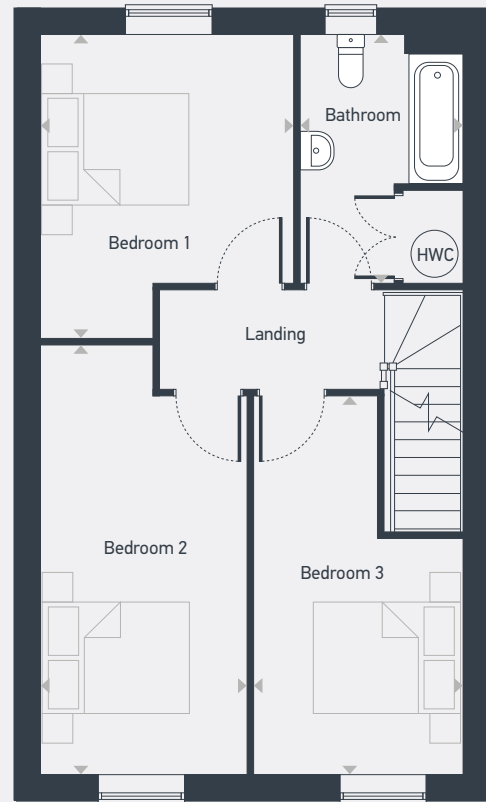

FIRST FLOOR

ST: Store WC: Water Closet HWC: Hot Water Cylinder

DIMENSIONS	m	ft
Living	5.45m x 3.18m	17'10" x 10'5"
Kitchen/Dining	6.22m x 3.03m	20'5" x 9'11"
Utility	1.52m x 0.63m	5'0" x 2'1"

DIMENSIONS	m	ft
Bedroom 1	3.91m (max) x 3.27m (max)	12'10" (max) x 10'9" (max)
Bedroom 2	5.53m (max) x 2.66m (max)	18'2" (max) x 8'9" (max)
Bedroom 3	4.89m (max) x 2.70m (max)	16'0" (max) x 8'10" (max)
Bathroom	3.21m x 2.09m	10'6" x 6'10"



01872 830 014 | placesforpeople.co.uk/the-gwel
Higher Newham Farm, Truro, TR1 2SN