



A place to
CONNECT

Step into something special with our stunning new collection of 1, 2 and 3 bedroom apartments at The Zinc Works.

Perfectly placed at the heart of Acton's vibrant, close-knit community, these beautifully designed homes offer the best of both worlds — peaceful green spaces close by and fast, effortless connections to central London and beyond. This is more than just a move; it's your chance to be part of somewhere you'll truly love to call home.

Stylish design meets
everyday practicality
at The Zinc Works.

CONNECT *with style*

Immerse yourself in an environment where every aspect of your apartment has been thoughtfully considered, from well-planned living spaces to beautifully appointed kitchens and bathrooms that meet every expectation for contemporary living.

CONNECT

with elevated living

Rising 19 storeys above Acton, The Zinc Works introduces a striking new presence on the skyline, with breathtaking views unfolding from its upper levels. Set within beautifully landscaped grounds and thoughtfully integrated alongside two existing apartment buildings and two new low-rise blocks, this is a place where architecture, outlook, and lifestyle come together seamlessly.



- B** Block B - Apartments for over 55s
- C** Block C - London Affordable Rent



PLOT LOCATOR

THE LAMMAS

1 bedroom apartment

- 3 4 9 10 15 16 21 22
- 27 28 33 34 39 40 45 46
- 51 52 57 58 63 64 69 70
- 75 76 81 82 87 88

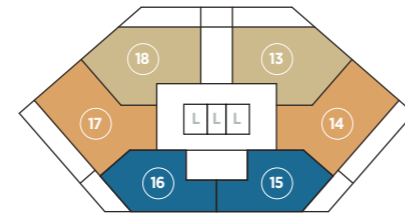

FLOOR 3

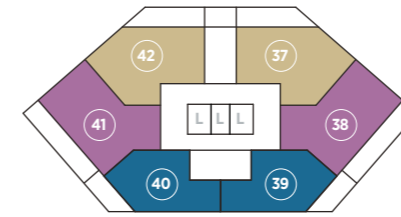

FLOOR 7

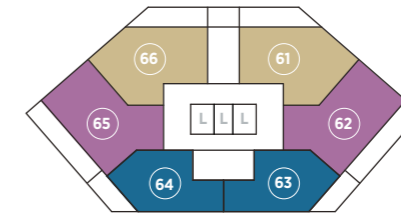

FLOOR 11

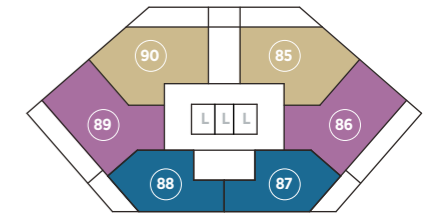

FLOOR 15

THE BRAMLEY

2 bedroom apartment

- 2 5 8 11 14 17 20 23
- 26 29 35

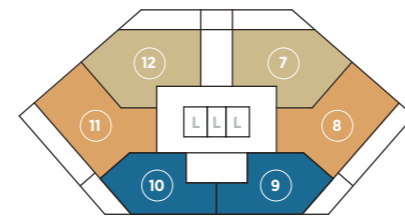

FLOOR 2

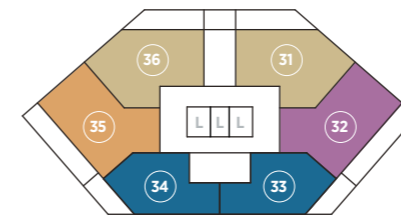

FLOOR 6

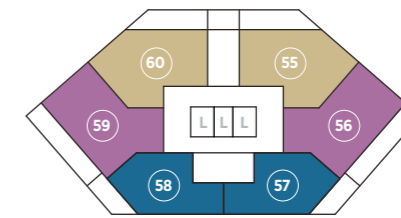

FLOOR 10

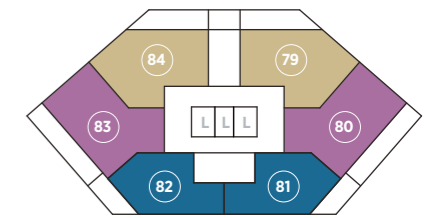

FLOOR 14

THE NORWOOD

2 bedroom apartment

- 32 38 41 44 47 50 53 56
- 59 62 65 68 71 74 77 80
- 83 86 89

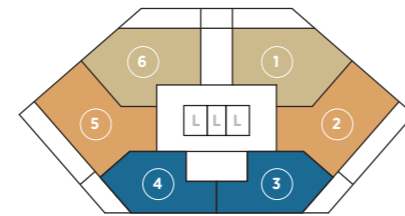

FLOOR 1

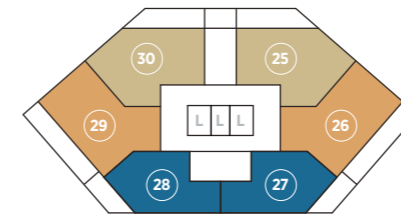

FLOOR 5

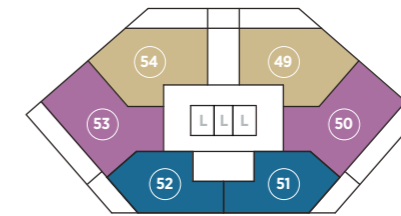

FLOOR 9

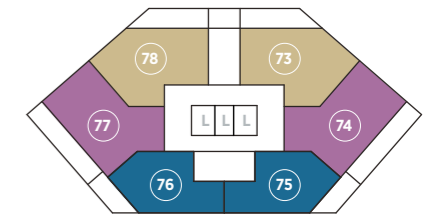

FLOOR 13

THE WALPOLE

2 bedroom apartment

- 1 6 7 12 13 18 19 24
- 25 30 31 36 37 42 43 48
- 49 54 55 60 61 66 67 72
- 73 78 79 84 85 90

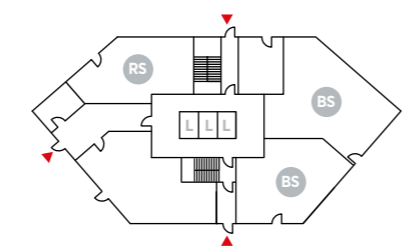

GROUND FLOOR

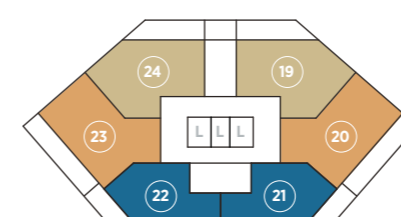

FLOOR 4

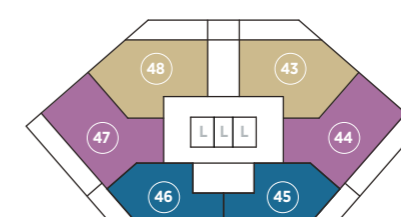

FLOOR 8

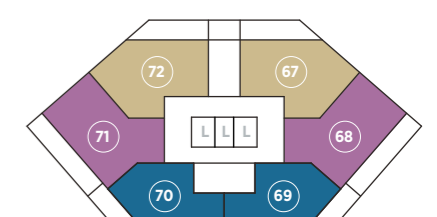

FLOOR 12

THE LAMMAS

1 bedroom apartment

Total Area **54.6m² 588ft²**

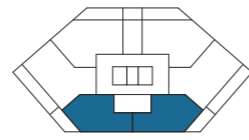

FLOORS 1 - 15



Plots as shown

- 3
- 9
- 15
- 21
- 27
- 33
- 39
- 45
- 51
- 57
- 63
- 69
- 75
- 81
- 87

Mirrored plots

- 4
- 10
- 16
- 22
- 28
- 34
- 40
- 46
- 52
- 58
- 64
- 70
- 76
- 82
- 88

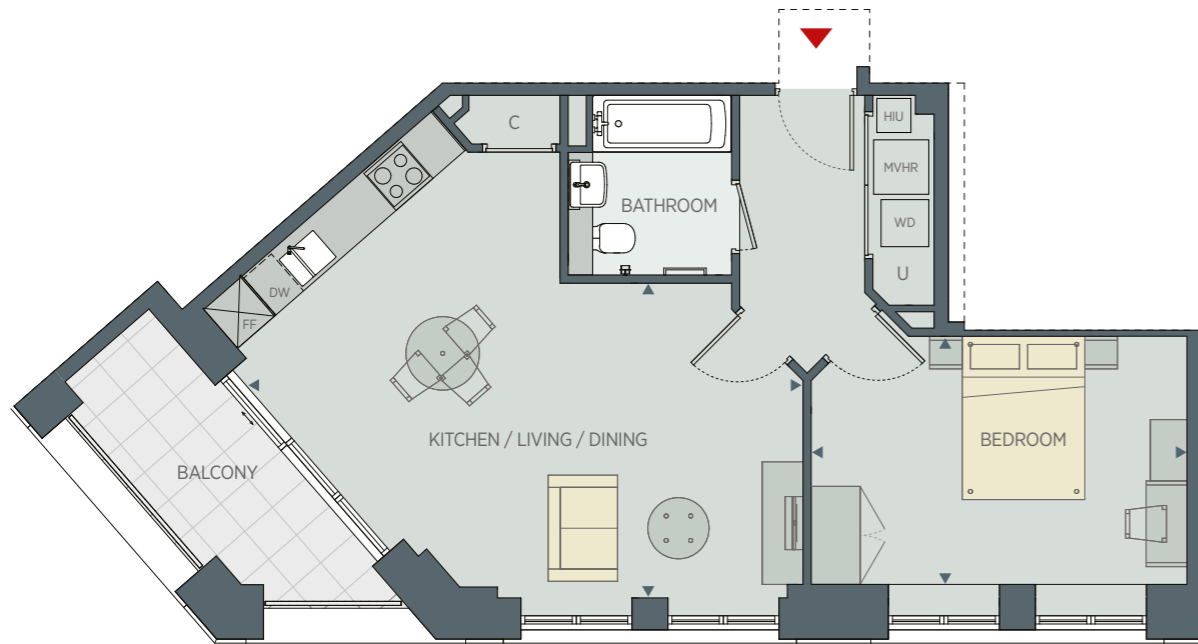

Kitchen / Living / Dining **6.68m x 3.85m 21'10" x 12'7"**

Bedroom **4.60m x 3.04m 15'1" x 9'11"**

U - UTILITY C - CUPBOARD MVHR - MECHANICAL VENTILATION HIU - HEAT INTERFACE UNIT WD - WASHER-DRYER FF - FRIDGE/FREEZER DW - DISHWASHER

The kitchen, furniture layouts and dimension on the following floor plans are for guidance only. Dimensions are taken from the points indicated and are not intended to be used for carpet sizes, appliance space or items of furniture. The sq m and sq ft are measured as gross internal areas using the RICS code to measuring. Apartment layouts shown here are for approximate measurements only. All measurements and areas may vary within a tolerance of 5%. Balconies may vary in size. Window arrangements may vary from floor to floor. Please speak to your Sales Executive for details.

THE BRAMLEY

2 bedroom apartment

Total Area **74.5m² 802ft²**

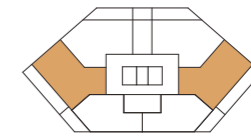

FLOORS 1 - 5

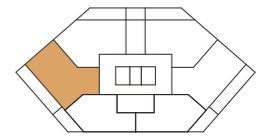

FLOOR 6



Plots as shown

- 2
- 8
- 14
- 20
- 26

Mirrored plots

- 5
- 11
- 17
- 23
- 29
- 35



Kitchen / Living / Dining **6.30m x 3.87m 20'8" x 12'8"**

Bedroom 1 **3.72m x 3.00m 12'2" x 9'10"**

Bedroom 2 **3.94m x 3.20m 12'11" x 10'5"**

U - UTILITY C - CUPBOARD MVHR - MECHANICAL VENTILATION HIU - HEAT INTERFACE UNIT WD - WASHER-DRYER FF - FRIDGE/FREEZER DW - DISHWASHER

The kitchen, furniture layouts and dimension on the following floor plans are for guidance only. Dimensions are taken from the points indicated and are not intended to be used for carpet sizes, appliance space or items of furniture. The sq m and sq ft are measured as gross internal areas using the RICS code to measuring. Apartment layouts shown here are for approximate measurements only. All measurements and areas may vary within a tolerance of 5%. Balconies may vary in size. Window arrangements may vary from floor to floor. Please speak to your Sales Executive for details.

THE NORWOOD

2 bedroom apartment

Total Area **74.5m² 802ft²**

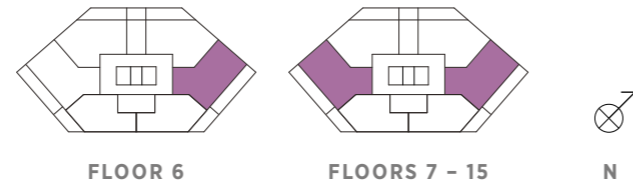

Plots as shown

- 32
- 38
- 44
- 50
- 56
- 62
- 68
- 74
- 80
- 86

Mirrored plots

- 41
- 47
- 53
- 59
- 65
- 71
- 77
- 83
- 89

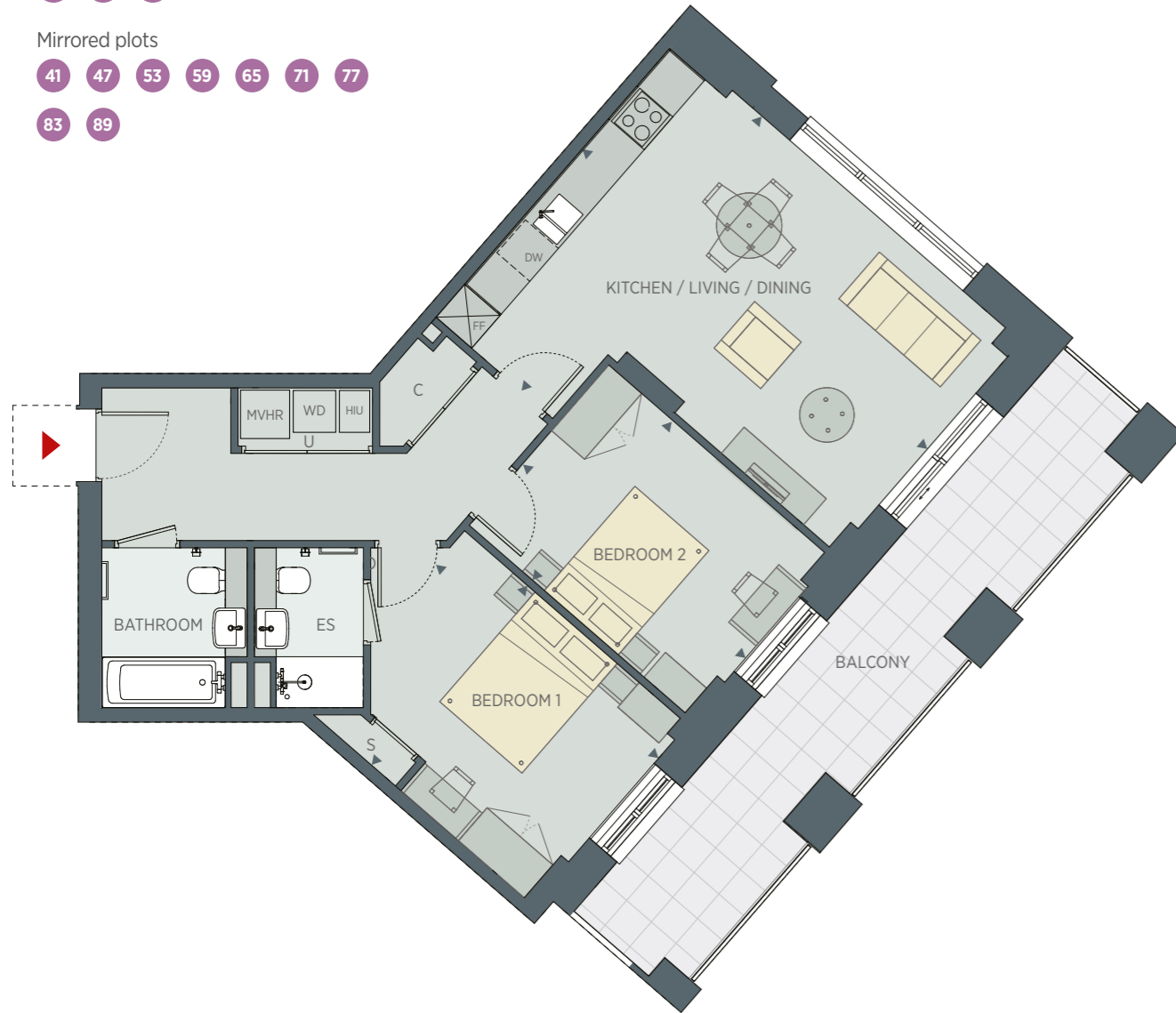

Kitchen / Living / Dining **6.30m x 3.87m 20'8" x 12'8"**

Bedroom 1 **3.94m x 3.35m 12'11" x 10'11"**

Bedroom 2 **4.07m x 2.85m 13'4" x 9'4"**

U - UTILITY C - CUPBOARD ES - EN SUITE MVHR - MECHANICAL VENTILATION HIU - HEAT INTERFACE UNIT WD - WASHER-DRYER FF - FRIDGE/FREEZER DW - DISHWASHER

The kitchen, furniture layouts and dimension on the following floor plans are for guidance only. Dimensions are taken from the points indicated and are not intended to be used for carpet sizes, appliance space or items of furniture. The sq m and sq ft are measured as gross internal areas using the RICS code to measuring. Apartment layouts shown here are for approximate measurements only. All measurements and areas may vary within a tolerance of 5%. Balconies may vary in size. Window arrangements may vary from floor to floor. Please speak to your Sales Executive for details.

THE WALPOLE

2 bedroom apartment

Total Area **73.3m² 789ft²**

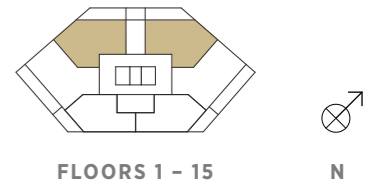

Plots as shown

- 1
- 7
- 13
- 19
- 25
- 31
- 37
- 43
- 49
- 55
- 61
- 67
- 73
- 79
- 85

Mirrored plots

- 6
- 12
- 18
- 24
- 30
- 36
- 42
- 48
- 54
- 60
- 66
- 72
- 78
- 84
- 90



Kitchen / Living / Dining **5.91m x 5.62m 19'4" x 18'5"**

Bedroom 1 **4.25m x 3.20m 13'11" x 10'5"**

Bedroom 2 **4.25m x 2.88m 13'11" x 9'5"**

U - UTILITY C - CUPBOARD ES - EN SUITE MVHR - MECHANICAL VENTILATION HIU - HEAT INTERFACE UNIT WD - WASHER-DRYER FF - FRIDGE/FREEZER DW - DISHWASHER

The kitchen, furniture layouts and dimension on the following floor plans are for guidance only. Dimensions are taken from the points indicated and are not intended to be used for carpet sizes, appliance space or items of furniture. The sq m and sq ft are measured as gross internal areas using the RICS code to measuring. Apartment layouts shown here are for approximate measurements only. All measurements and areas may vary within a tolerance of 5%. Balconies may vary in size. Window arrangements may vary from floor to floor. Please speak to your Sales Executive for details.

SPECIFICATION

Apartments at The Zinc Works won't disappoint on quality and style, with thoughtful specifications designed to meet the needs of today's lifestyles.



Computer generated illustration indicative only

KITCHEN

- Matt handleless kitchen cabinets in Pebble Grey Silk
- Silestone worktop and 100mm upstand
- 1.5 bowl sink
- Neff built-in single oven with Slide & Hide door
- Neff ceramic 4 zone hob
- Neff canopy hood
- Neff integrated 70/30 fridge/freezer
- Neff integrated dishwasher with Home Connect
- Bosch freestanding washer-dryer in utility cupboard
- LED strip under pelmet lighting

BATHROOM & EN SUITES

- Contemporary white sanitaryware
- Ideal Standard concealed cistern WC
- Wall-mounted semi-recessed wash basin with mixer tap
- Bath with hinged frameless glass shower screen to bathroom
- Thermostatic shower mixer
- City Touchstone light grey floor and 1901 Jeffrey Moss wall tiling to bathroom
- Bathroom cabinet with integrated mirror
- Chrome heated towel rail

ELECTRICAL / LIGHTING

- Sky Q outlets in living room & bedroom
- Incoming fibre optic provision
- Recessed downlighters throughout
- Shaver socket in bathroom
- Mains operated smoke and heat detectors
- Video intercom access

HEATING

- Underfloor heating throughout

FLOORING

- Timber effect vinyl flooring to kitchen, dining and living room
- Neutral carpet to bedrooms

GENERAL

- Fitted wardrobe to bedroom 1 only
- Private balcony to all apartments
- Sprinkler system to all homes

BUILDING AMENITIES

- Communal bike store
- Three resident lifts to all floors
- Ground floor lobby CCTV

WARRANTY

- LABC 12-year warranty

